

**特性 Characteristic**

- 最大切换容量为20安培, 低功耗0.6W  
 Switching capability: 20A, low power consumption: 0.6W.
- 超微型, 标准印刷线路板式 Microminiature, standard PCB type.
- 高防震, 防冲击性能 High vibration and shock resistance.

**安规认证 Safety Approval: CQC**
**订货标记 Ordering Information**

型号命名规则 Model Naming Rules	
DED-T78	-DC 12V H -A S X
	安装方式: 无: PCB Mounting Type: Blank: PCB 封装方式: S: 密封型 SH: 防水型 Enclosure Type: S: Plastic sealed type. SH: Sealed type washable 触点形式: A: 常开型, B: 常闭型, C: 转换型 U: 二组常开型 Contact Form: A: Form A, B: Form B, C: Form C, U: 2 Form A 线圈功耗: 无: 0.36W, H: 0.60W, D: 0.8W Coil Power: Blank: 0.36W, H: 0.60W, D: 0.8W 线圈电压: 5V, 6V, 9V, 12V, 24V Coil Voltage: 5V, 6V, 9V, 12V, 24V 线圈性质: DC: 直流 Coil Type: DC: Direct current 产品型号: DED-T78 Model: DED-T78

**线圈参数 Coil Data (at 20°C)**

额定电压 Rated Voltage (VDC)	额定电流 Rated Current ±10% (mA)	线圈电阻 Coil Resistance ±10% (Ω)	最大连续外加电压 Max. Continuous Voltage Applied	吸合电压 Pick Up Voltage (Max.)	释放电压 Drop Out Voltage (Min.)	额定功率 Power Consumption At Rated Voltage
5	120.00	41.7	额定电压的110% 110% of rated voltage	额定电压的70% 70% of rated voltage	额定电压的5% 5% of rated voltage	约 Approximately 0.60W
6	100.00	60				
9	66.67	135				
12	50.00	240				
24	25.00	960				

**触点负载 Contact Rating**

型号 Model	DED-T78
阻性负载 Resistive Load	20A 14VDC
最大切换电流 Max. Switching Current	20A
最大切换电压 Max. Switching Voltage	30VDC
最大切换功率 Max. Switching Power	280W

## 规格说明 Specification

触点材料 Contact Material	银合金 Ag Alloy	
接触电阻 Contact Resistance	100mΩ Max.	
吸合时间 Operate Time	10ms. Max.	
释放时间 Release Time	5ms. Max.	
绝缘电阻 Insulation Resistance	100MΩ Min.(DC500V)	
介质耐压 Dielectric Strength	触点与触点间 Between open contact; AC500V, 50/60Hz 1min.	
	线圈与触点间 Between coil and contact; AC1,000V, 50/60Hz 1min.	
抗振动 Vibration Resistance	耐久 Endurance	10~55Hz, 双振幅 1.5 mm 10~55Hz, 1.5 mm double amplitude
	误动作 Misoperation	10~55Hz, 双振幅 1.5 mm 10~55Hz, 1.5 mm double amplitude
抗冲击 Shock Resistance	耐久 Endurance	10g Min.
	误动作 Misoperation	100g Min.
寿命 Life	机械寿命 Mechanical Life	10,000,000 operations
	电气寿命 Electrical Life	100,000 operations
环境温度 Ambient Temperature	-40°C~+125°C	
重量 Weight	约 Approx. 6.0g	

## 外形尺寸、接线、安装孔位图(mm)

## Outline Dimensions, Wiring Diagram, Mounting Hole Layout (mm)

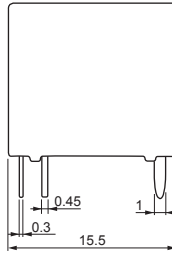
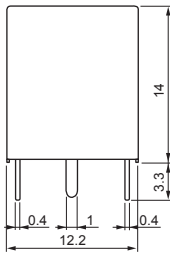

未标注尺寸公差 Dimension tolerance

<1mm: ±0.2mm  
1~5mm: ±0.3mm  
>5mm: ±0.4mm

注(Note):

安装孔尺寸公差 ±0.1mm  
Dimension tolerance of the mounting hole ±0.1mm

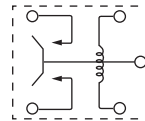
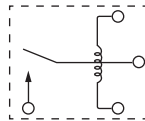
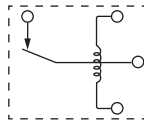
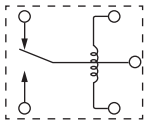

接线图(底视图) Wiring Diagram (Bottom View)

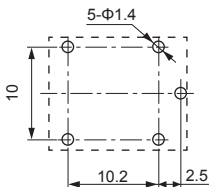

1c

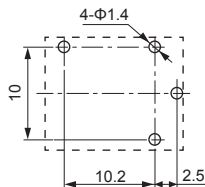

1b

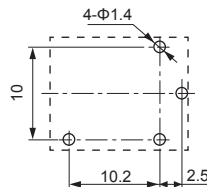

1a

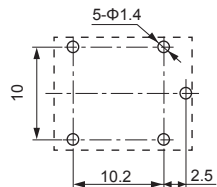

1u

安装孔位图(底视图) Mounting Hole Layout (Bottom View)

## 典型用途 Typical Applications

- 汽车门锁, 马达控制, 家电, 办公设备, 自动防盗报警器等  
Auto door lock, motor control, household appliances, office equipment, anti-theft alarm, etc.

## 性能曲线图 Performance Curves

